

Leigh Farm Park

Future Directions for Leigh Farm Park

Original park property acquisition

- City of Durham
- County of Durham
- NC Dept. of Environmental Resources
- Triangle Land Conservancy
- Other non-profit Organizations



National Register Historic Area

- The historic area consists of 8 buildings on 7 acres in the core of the site. The State owns all these buildings except for one; the City has leased this area from the State.

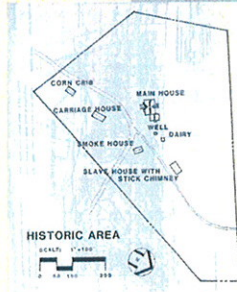

More than just an old house...

- In the late 19th and early 20th centuries, the Leigh farmstead was divided up. African American and white farmers lived as neighbors and shopped at the same local mills and stores.

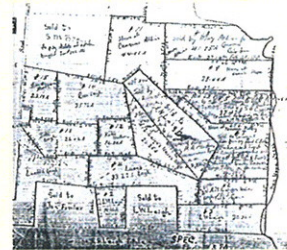

The historic site



Assessment in 2006



2006 Assessment (Edwards-Pitman)

■ PRIORITY REPAIR OUTLINE

■ The following list outlines the most pressing repair needs at Leigh Farm. A detailed scope of work follows on subsequent pages.

■ Dairy Roof Replacement, Siding and Corner Post Repair	\$ 1,865.00
■ Slave Cabin #1 Restoration	\$ 78,977.56
■ Tobacco Barn Foundation Repair, Log Repair and Replacement,	\$ 14,134.00
■ Slave Cabin #2 Log Repair and Replacement, Rear Porch Replacement	\$ 15,000.00
■ Pack House Repair	\$ 10,790.00
■ Application of Glycol/Borate wood preservative to log buildings	\$ 3,710.00
■ Leigh House Foundation Stabilization	\$ 100,000.00
■ Leigh House Chimney Stabilization and Reconstruction	\$ 25,000.00
■ Installation of Security and Fire Detection Systems (see spec sheet)	\$ 69,965.00

■ **TOTAL COST OF PRIORITY REPAIRS** **\$ 319,441.56**

■ **RENOVATION WORK FUNDED BY 2005 BOND**

Bringing the park on-line...

Innovative Programming is Key to Viability

Given the number of other museums and historic sites in the surrounding counties, Leigh Farm Park needs to complement, not replicate, recreational and historical activities already available to the public. The breadth of Leigh Farm's history and its intact 90-acre setting allow for a great diversity of uses, from recreation and environmental conservation to historic interpretation and farming. Dynamic, interactive and sophisticated programming is imperative for the property's long-term viability. Adequate support staff and creative cooperative agreements are critical for the park's success.

Proposed Partnerships for Leigh Farm

- Durham Orange Recreational Disc Golf Association (DORDA)
- South Eastern Efforts Developing Sustainable Spaces (SEEDS)
- Piedmont Wildlife Center
- Leigh Farm Park Advisory Board

DORDA



- DPR is supporting DORDA's application for a Durham County Open Space grant for development of a disc golf course at Leigh Farm Park.



- The course would be developed with DPR staff and volunteers from DORDA and Jordan H. S.

SEEDS



- SEEDS is seeking grant funding to restore the historic gardens at Leigh Farm Park, using students and volunteers.



- SEEDS staff would work with young people as gardening volunteers (as in their DIG program now) and also teach gardening classes.

Piedmont Wildlife Center



- Mission: To support native North American wildlife through rehabilitation, education, and scientific study, with emphasis given to the conservation of wildlife and its habitat in North Carolina.



Partnerships

- Use of park land for DORDA
- Use of park land and arrangement for classes for SEEDS
- Use of park land, lease of buildings on park site, and arrangements for classes for Piedmont Wildlife Center

Leigh Farm: shared use



Leigh Farm Park Proposed Future Development

Issues, Problems, or Questions