

Appendices

Diagrams

 **Single Family Detached Dwelling**

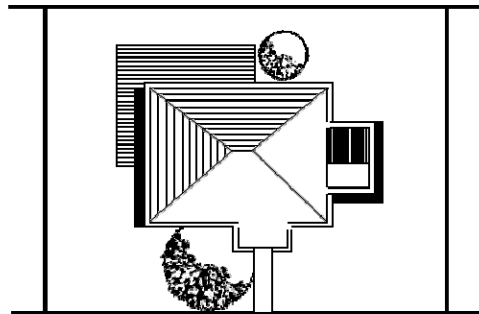

Diagram 1

 **Duplex**

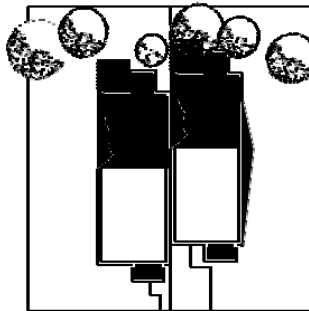

Diagram 2

 **Triplex**

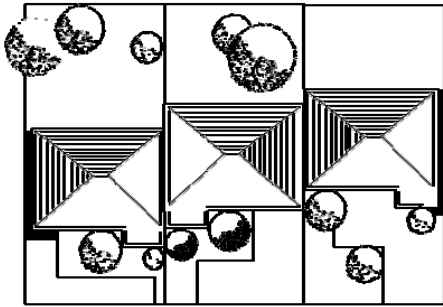

Diagram 3

 **Townhouses**

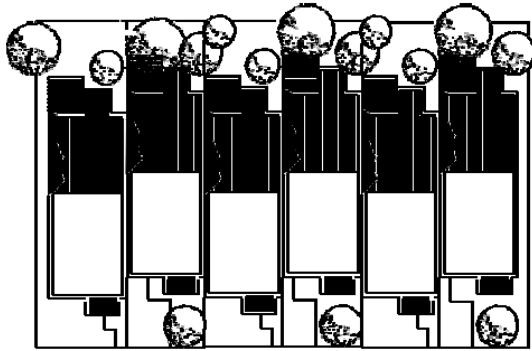

Diagram 4

 **Zero Lot Line Houses**

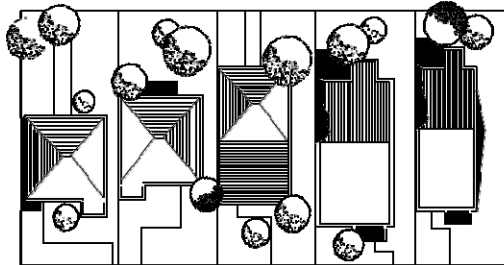
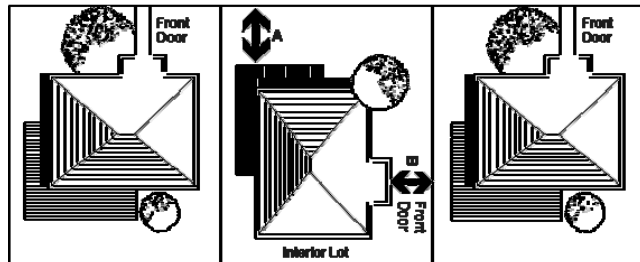

Diagram 5

 **Street**



The distance shown above as "B", must equal or exceed "A", when the front door is on the side of an interior lot.

Diagram 6

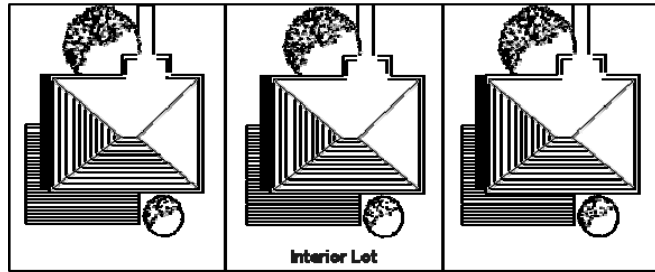

Diagram 7

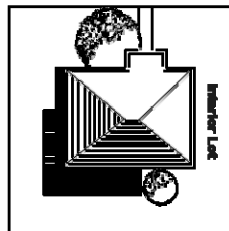

Diagram 8

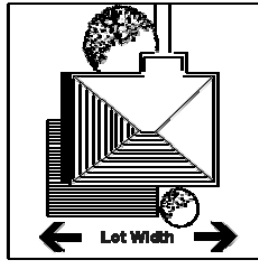

Diagram 9

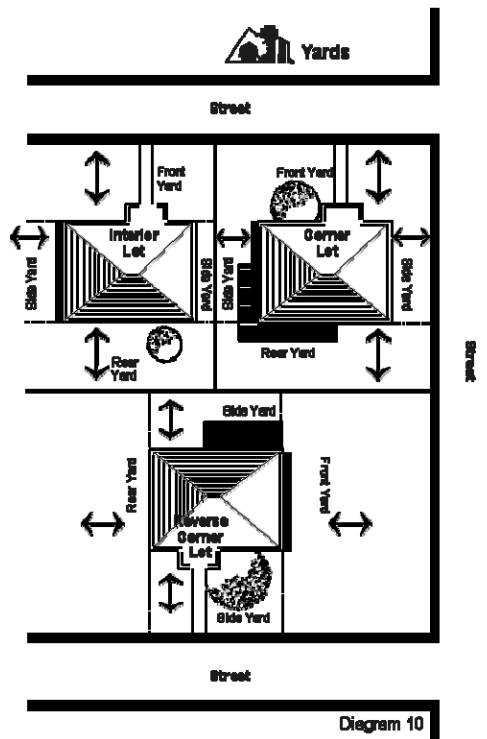

Diagram 10



### Signs: Awning, Window, Wall

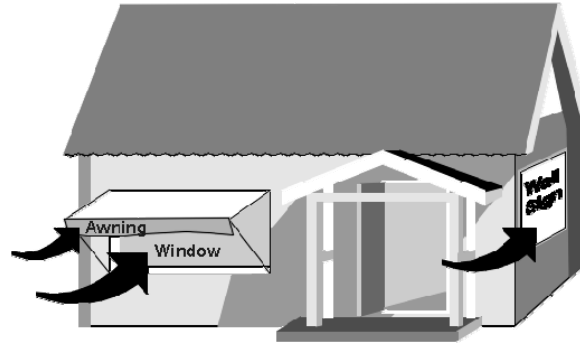
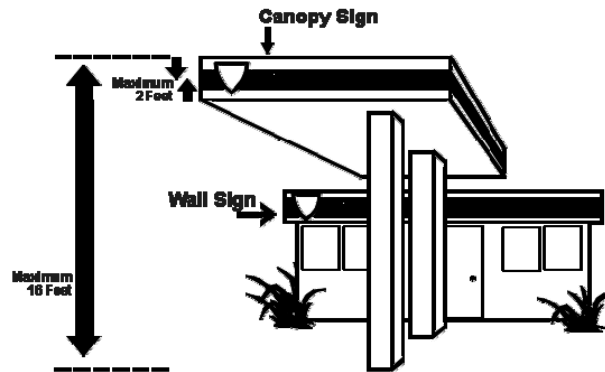

Diagram 12



### Signs for Canopies



**Maximum Canopy Sign Area  
12 Square Feet/Side**

**SIC CODES**

An outline of the Standard Industrial Classification (SIC) Coding.

(For more complete information see Standard Industrial Classification Manual, 1987)

<b>Major Group</b>	<b>Industry Number</b>	<b>Short Title</b>
<i>Construction</i>		
15	1	Building Construction-General Contractors
16		Heavy Construction Contractors
17		Special Trade Contractors
<i>Manufacturing</i>		
20		Food and Kindred Products
	201	Meat Products
	202	Dairy Products
	203	Canned, Frozen or Preserved Fruits and Vegetables
	204	Grain Mill Products
	205	Bakery Products
	206	Sugar and Confectionery Products
	207	Fats and Oils
	208	Beverages
	209	Miscellaneous Food and Kindred Products
21		Tobacco Products
22		Textile Mill Products
23		Apparel and other Textile Products
24		Lumber and Wood Products
25		Furniture and Fixtures
26		Paper and Allied Products
27		Printing and Publishing
28		Chemicals and Allied Products
	281	Industrial Inorganic Chemicals
	282	Plastics Materials and Synthetics
	283	Drugs
	284	Soap, Cleaners, and Cosmetics
	285	Paints and Allied Products
	286	Industrial Organic Chemicals
	287	Agricultural Chemicals
	288	N/A
	289	Miscellaneous Chemical Products
29		Petroleum Refining and Cola Products
30		Rubber and Miscellaneous Plastics
31		Leather and Leather Products
32		Stone, Clay, Glass and Concrete Products
33		Primary Metal Industries
	331	Blast Furnaces and Steel Products
	332	Iron and Steel Foundries
	333	Primary Nonferrous Metals
	334	Secondary Nonferrous Metals
	335	Nonferrous Rolling and Drawing
	336	Nonferrous Foundries
	339	Miscellaneous Primary Metal Products
34		Fabricated Metal Products

35		Industrial Machinery and Equipment
	351	Engines and Turbines
	352	Farm and Garden Machinery
	353	Construction and Related Machinery
	354	Metalworking Machinery
	355	Special Industry Machinery
	356	General Industrial Machinery
	357	Computer and Office Equipment
	358	Refrigeration and Service Machinery
	359	Industrial Machinery, Miscellaneous
36		Electronic and Other Electric Equipment
	361	Electric Distribution Equipment
	362	Electrical Industrial Apparatus
	363	Household Appliances
	364	Electric Lighting and Wiring Equipment
	365	Household Audio and Video Equipment
	366	Communications Equipment
	367	Electronic Components and Accessories
	368	N/A
	369	Miscellaneous Electrical Equipment and Supplies
37		Transportation Equipment
38		Instruments and Related Products
39		Miscellaneous Manufacturing Industries
<i>Transportation and Utilities</i>		
40		Railroad Transportation
41		Local and Interurban Passenger Transit
42		Trucking and Warehousing
43		U.S. Postal Service
44		Water Transportation
45		Air Transportation
46		Pipelines
47		Transportation Services
	472	Passenger Transportation
	473	Freight Transportation
	478	Miscellaneous Transportation Services
48		Communications
49		Electric, Gas and Sanitary Services
<i>Wholesale Trade</i>		
50		Wholesale Trade Durable Goods
51		Wholesale Trade Nondurable Goods