

DOCUMENT 00 91 13

ADDENDA

ADDENDUM NUMBER 1

DATE: January 13, 2020

PROJECT: Alpine Road Culvert Replacement

CONTRACT NUMBER: SD-2020-04

OWNER: The City of Durham

ENGINEER: Horvath Associates, P.A.

TO: Prospective Bidders

This Addendum forms a part of the Contract Documents and modifies the Bidding Documents dated December 23, 2019 with amendments and additions noted below.

Acknowledge receipt of this Addendum in the space provided in the Bid form. Failure to do so may disqualify the Bidder.

This Addendum consists of 14 pages.

CHANGES TO THE PROJECT MANUAL (2 pages)

1. Remove cover sheets 1 and 2 and replace with the cover sheets included with this addendum.

DOCUMENT 00 01 10 - TABLE OF CONTENTS (2 pages)

2. Remove document 00 01 10 – TABLE OF CONTENTS, dated December 23, 2019 and replace with document 00 01 10 – TABLE OF CONTENTS, dated January 13, 2020 included with this addendum.

DOCUMENT 00 31 00 – AVAILABLE PROJECT INFORMATION (4 pages)

3. Remove document 00 31 00 – AVAILABLE PROJECT INFORMATION, dated December 23, 2019 and replace with document 00 31 00 – AVAILABLE PROJECT INFORMATION, dated January 13, 2020 included with this addendum.

DOCUMENT 00 41 43 – BID FORM – UNIT PRICE (SINGLE PRIME CONTRACT) (1 page)

4. Remove the UNIT PRICE WORK FORM found in document 00 41 43 – BID FORM – UNIT PRICE (SINGLE-PRIME CONTRACT), dated December 23, 2019 and replace with UNIT PRICE WORK FORM, dated January 13, 2020 included with this addendum.

DOCUMENT 00 52 15 – AGREEMENT FORM – EJCDC STIPULATED SUM (SINGLE-PRIME CONTRACT) (1 page, same as no. 4 above)

5. Remove the UNIT PRICE WORK FORM found in document 00 52 15 – AGREEMENT FORM – EJCDC STIPULATED SUM (SINGLE-PRIME CONTRACT), dated December 23, 2019 and replace with UNIT PRICE WORK FORM, dated January 13, 2020 included with this addendum.

DOCUMENT 30 11 00 – PROJECT SPECIAL PROVISIONS (1 page)

6. Add the Project Special Provisions and Technical Specifications Seals included with this addendum to this section.

CHANGES TO THE DRAWINGS (1 page)

7. The LIST OF DRAWINGS included in document 00 31 00, dated January 13, 2020 includes the correct and updated Drawings included in this Contract. The Drawings may be downloaded from the Project web page: <https://durhamnc.gov/3909>.
  - a. Drawing “2431 ALPINE ROAD DRIVEWAY PLAN”, dated 01/13/2020 was added to the LIST OF DRAWINGS and is included with this addendum.
    - i. A second permanent driveway is being added to the project to allow access to the property at 2431 Alpine Road. Additional Unit Price Work quantities have been included in the UNIT PRICE WORK FORM.

CLARIFICATIONS TO THE DRAWINGS (1page)

8. Clarification was sought on detail C-1 on Drawing C302 during the Pre-Bid Conference held on January 6, 2020. Clarification is included with this addendum.

END OF DOCUMENT

**CITY OF DURHAM**

**PROJECT MANUAL**

**INCLUDING**

**BIDDING DOCUMENTS, CONTRACT DOCUMENTS, AND  
TECHNICAL SPECIFICATIONS**

**FOR**



**CITY OF  
DURHAM**



*01/13/2020*

**CONTRACT: SD-2020-04**

**December 23, 2019, Revised January 13, 2020**

**Project:**

**Alpine Road Culvert Replacement**

Stormwater & GIS Services Division  
Public Works Department  
101 City Hall Plaza, Durham NC 27701

**CONTRACT: SD-2020-04**

**December 23, 2019, Revised January 13, 2020**

**PROJECT:  
Alpine Road Culvert Replacement**

**STORMWATER & GIS SERVICES DIVISION  
PUBLIC WORKS DEPARTMENT  
CITY OF DURHAM NC**

DOCUMENT 00 01 10

TABLE OF CONTENTS

Section Title

PROCUREMENT AND CONTRACTION REQUIREMENTS GROUP  
DIVISION 00 - PROCUREMENT AND CONTRACTING REQUIREMENTS  
INTRODUCTORY INFORMATION

00 01 10 Table of Contents

PROCUREMENT REQUIREMENTS

00 11 16 Invitation to Bid  
00 21 15 Instructions to Bidders - EJCDC  
00 31 00 Available Project Information  
00 41 43 Bid Form - Unit Price (Single-Prime Contract)

CONTRACTING REQUIREMENTS

00 52 15 Agreement Form - EJCDC Stipulated Sum (Single-Prime Contract)  
00 72 15 General Conditions - EJCDC Stipulated Sum (Single-Prime Contract)  
C-700 EJCDC Standard General Conditions of the Construction Contract

SPECIFICATIONS GROUP  
GENERAL REQUIREMENTS SUBGROUP  
DIVISION 01 - GENERAL REQUIREMENTS

01 10 00 Summary  
01 20 00 Price and Payment Procedures  
01 30 00 Administrative Requirements  
01 33 00 Submittal Procedures

SITE AND INFRASTRUCTURE SUBGROUP  
DIVISION 30 - MISCELLANEOUS

30 11 00 Project Special Provisions

TECHNICAL SPECIFICATIONS

30 11 23 Pre-Cast Concrete Box Culvert  
30 11 29 Falsework and Formwork  
30 11 30 Submittal of Working Drawings  
30 11 31 Crane Safety  
30 11 32 Grout for Structures

## ADDENDA

00 91 13      Addendum Number 1

## LIST OF APPENDICES

Appendix A	Underutilized Business Enterprises (UBE) Participation Goals
Appendix B	EBOP Construction Forms
Appendix C	UBE Subcontracting Reporting Forms
Appendix D	HUB Listing
Appendix E	Non-Collusion Affidavit Forms for Bidder and Subcontractor
Appendix F	Bid Bond Forms
Appendix G	Performance Bond and Payment Bond Forms
Appendix H	Reimbursable Sales and Use Tax Statement Forms
Appendix I	Contractor Safety Record Information
Appendix J	Not Used
Appendix K	Not Used

END OF SECTION

DOCUMENT 00 31 00

AVAILABLE PROJECT INFORMATION

1.1 SUMMARY

- A. Document Includes:
1. Project information and location.
  2. List of drawings.
  3. Subsurface investigation report.
  4. Topographic survey.
  5. Existing conditions survey.
  6. City of Durham standards.
  7. North Carolina Department of Transportation (NCDOT) standards.
  8. North Carolina Department of Environment and Natural Resources (NCDENR) standards.
- B. Related Documents:
1. 00 21 15 - Instructions to Bidders - EJCDC: Examination of Bidding Documents, other related data, and Site.

1.2 PROJECT INFORMATION AND LOCATION

- A. The Work contemplated under the provisions of this Contract includes, but may not be limited to, furnishing of all materials, labor, equipment, tools, etc. unless otherwise specified, for the complete replacement of the existing storm drainage culvert where Alpine Road intersects Tributary C of Third Fork Creek.
- B. The Work Site for this Contract include, but are not limited to, the following:
1. Alpine Road Culvert Replacement (ROW-143)

1.3 LIST OF DRAWINGS

Contract includes the following Drawings:

No.	Drawing Title	Issue Date
C000	COVER SHEET	11/19/2018
C001	EXISTING CONDITION	11/19/2018
C300	POPOSED CONDITIONS OVERALL PLAN VIEW	11/19/2018
C301	PLAN AND PROFILES	12/21/2018
C302	CULVERT DETAILS	12/21/2018
C303	UTILITY DETAILS	11/19/2018
S1	CULVERT STRUCTURAL DRAWINGS	11/15/2018

S2	CULVERT STRUCTURAL DRAWINGS	11/15/2018
S3	CULVERT STRUCTURAL DRAWINGS	11/15/2018
S4	CULVERT STRUCTURAL DRAWINGS	11/15/2018
TMP-1	TRANSPORTATION MANAGEMENT PLAN	11/14/2018
TMP-1A	TRANSPORTATION MANAGEMENT PLAN	11/14/2018
TMP-1B	TRANSPORTATION MANAGEMENT PLAN	11/14/2018
TMP-2A	SPECIAL SIGN DESIGN	11/14/2018
TMP-2B	SPECIAL SIGN DESIGN	11/14/2018
TMP-3	OFF SITE DETOUR DETAILS	11/14/2018
N/A	2431 ALPINE ROAD DRIVEWAY PLAN	01/13/2020

#### 1.4 SUBSURFACE INVESTIGATION REPORT

- A. A subsurface investigation has been conducted in advance of the Project. This may be downloaded at <https://durhamnc.gov/3960>.
  - 1. “Geotechnical Report of Subsurface Investigation Alpine Road Culvert Replacement,” dated February 14, 2018.

#### 1.5 STREAM FLOW INFORMATION

- A. Stream flow information for Third Fork Creek Tributary C at Alpine Road is available via the Project web page, <https://durhamnc.gov/3960>.

#### 1.6 TOPOGRAPHIC SURVEY

- A. A topographic survey was performed for the Project Site.

#### 1.7 EXISTING CONDITIONS SURVEY

- A. Existing conditions for the Alpine Road Site can be seen on sheet C001 of the Drawings.

#### 1.8 CITY OF DURHAM STANDARDS

- A. All Work shall conform to City of Durham Standards, Specifications, and Standard Details. These may be downloaded at: <http://durhamnc.gov/3626>.

#### 1.9 NORTH CAROLINA DEPARTMENT OF TRANSPORTATION (NCDOT) STANDARDS

- A. All Work shall conform to the NCDOT Standard Specifications (current version) and applicable revisions, as referenced in the Technical Specifications. The NCDOT



Standard Specifications may be downloaded at:

<https://connect.ncdot.gov/resources/Specifications/Pages/2018-Specifications-and-Special-Provisions.aspx>. Hard copies of these documents may be obtained from the NCDOT and are not provided by the City of Durham.

1. The following NCDOT Standard Specifications are directly referenced for the Work included in this Contract:
  - a. Section 200 – Clearing and Grubbing
  - b. Section 240 – Ditch Excavation
  - c. Section 250 – Removal of Existing Pavement
  - d. Section 310 – Pipe Culverts
  - e. Section 410 – Foundation Excavation
  - f. Section 414 – Box Culvert Excavation
  - g. Section 420 – Concrete Structures
  - h. Section 425 – Fabricating and Placing Reinforcement
  - i. Section 545 – Incidental Stone Base
  - j. Section 607 – Milling Asphalt Pavement
  - k. Section 610 – Asphalt Concrete Plant Mix Pavements
  - l. Section 800 – Mobilization
  - m. Section 840 – Minor Drainage Structures
  - n. Section 848 – Concrete Sidewalks, Driveways, and Curb Ramps
  - o. Section 876 – Rip Rap
  - p. Section 903 – Ground Mounted Sign Supports
  - q. Section 1016 – Select Materials
  - r. Section 1056 – Geosynthetics
  - s. Section 1110 – Work Zone Signs
  - t. Section 1145 – Barricades
  - u. Section 1510 – Water Lines
  - v. Section 1520 – Sanitary Sewer
  - w. Section 1525 – Utility Manholes
  - x. Section 1540 – Encasement
  - y. Section 1605 – Temporary Silt Fence
  - z. Section 1606 – Special Sediment Control Fence
  - aa. Section 1630 – Construction and Maintenance of Silt Detention Devices
  - bb. Section 1631 – Rolled Erosion Control Products
  - cc. Section 1632 – Rock Inlet Sediment Trap
  - dd. Section 1635 – Rock Pipe Inlet Sediment Trap
  - ee. Section 1660 – Seeding and Mulching
  
- B. All Work shall conform to the NCDOT Standard Drawings (current version) and applicable revisions, as referenced in the Technical Specifications. The NCDOT Standard Drawings may be downloaded at:  
<https://connect.ncdot.gov/resources/Specifications/Pages/2018-Roadway-Standard-Drawings.aspx>. Hard copies of these documents may be obtained from the NCDOT and are not provided by the City of Durham.
  1. The following NCDOT Standard Details are directly referenced for the Work included in this Contract:
    - a. Detail 300.01 – Method of Pipe Installation
    - b. Detail 840.04 – Concrete Open Throat Catch Basin

- c. Detail 840.05 – Brick Open Throat Catch Basin
- d. Detail 840.54 – Manhole Frame and Cover
- e. Detail 1605.01 – Temporary Silt Fence
- f. Detail 1606.01 – Special Sediment Control Fence
- g. Detail 1630.06 – Special Stilling Basin
- h. Detail 1631.01 – Matting Installation
- i. Detail 1632.02 – Rock Inlet Sediment Trap Type B
- j. Detail 1635.02 – Rock Pipe Inlet Sediment Trap Type B

1.10 NORTH CAROLINA DEPARTMENT OF ENVIRONMENT AND NATURAL RESOURCES  
(NCDENR) STANDARDS

- A. All work shall conform to the NCDENR Erosion and Sediment Control Planning and Design Manual (current version), as referenced in the Technical Specifications. The NCDENR manual may be downloaded at: <https://deq.nc.gov/about/divisions/energy-mineral-land-resources/energy-mineral-land-permit-guidance/erosion-sediment-control-planning-design-manual>. Hard copies of this document may be obtained from the NCDENR and are not provided by the City of Durham.

END OF DOCUMENT

**ALPINE ROAD CULVERT REPLACEMENT (SD-2020-04)**

UNIT PRICE WORK FORM

Standard							
No.	Specification	Drawing	Item Description	Unit	Quantity	Unit Price	Item Value
<b>Abandonment, Demolition, and Removal</b>							
A1	NCDOT 200	N/A	Select Tree Removal (4 to 8-inch diameter)	EA	2		
A2	NCDOT 200	N/A	Select Tree Removal (8.1 to 16-inch diameter)	EA	10		
A3	NCDOT 200	N/A	Select Tree Removal (16.1 to 24-inch diameter)	EA	2		
A4	NCDOT 200	N/A	Select Tree Removal (24.1 to 36-inch diameter)	EA	2		
A5	NCDOT 250	N/A	Removal of Existing Asphalt Pavement	SY	245		
A6	N/A	N/A	Temporary Relocation of Mailbox	EA	2		
<b>Subtotal for Abandonment, Demolition, and Removal</b>							
<b>Earthwork</b>							
A7	NCDOT 240	N/A	Drainage Ditch Excavation	CY	80		
A8	NCDOT 414	N/A	Culvert Excavation	LS	1		
A9	NCDOT 410/1016	N/A	Select Backfill Material (Class II)	CY	660		
<b>Subtotal for Earthwork</b>							
<b>Soil Erosion and Sediment Control</b>							
A10	NCDOT 876	N/A	Rip Rap, Class 1	TN	215		
A11	NCDOT 876/1056	N/A	Geotextile for Drainage (Type 2)	SY	280		
A12	NCDOT 1605	NCDOT 1605.01	Temporary Silt Fence	LF	340		
A13	NCDOT 1606	NCDOT 1606.01	Special Sediment Control Fence	LF	30		
A14	NCDOT 1631	NCDOT 1631.01	Matting for Erosion Control	SY	400		
A15	NCDOT 1660	N/A	Seeding and Mulching	SY	1200		
A16	NCDOT 1630	NCDOT 1630.06	Special Stilling Basin	EA	2		
A17	NCDOT 1632	NCDOT 1632.02	Rock Inlet Sediment Trap Type B	EA	1		
A18	NCDOT 1635	NCDOT 1635.02	Rock Pipe Inlet Sediment Trap Type B	EA	2		
A19	N/A	N/A	Surface Water Diversion/Pump Around	LS	1		
<b>Subtotal for Soil Erosion and Sediment Control</b>							
<b>Traffic Control</b>							
A20	NCDOT 903	N/A	Supports, 3-lb Steel U-Channel	LF	630		
A21	NCDOT 1110	N/A	Work Zone Signs (Stationary)	SF	601		
A22	NCDOT 1110	N/A	Work Zone Signs (Barricade Mounted)	SF	74		
A23	NCDOT 1145	N/A	Barricades (Type III)	LF	64		
<b>Subtotal for Traffic Control</b>							
<b>Paving</b>							
A24	NCDOT 545	N/A	Incidental Stone Base	TN	115		
A25	NCDOT 607	N/A	Milling Asphalt Pavement, 1.5-inch Depth	SY	45		
A26	NCDOT 610	N/A	Asphalt Concrete Surface Course, Type S9.5A	TN	21		
A27	NCDOT 610	N/A	Asphalt Concrete Surface Course, Type S9.5B	TN	25		
A28	NCDOT 848	<a href="#">CoD SSD</a>	6-inch Concrete Driveway City Detail No. ST-9.0 and ST-10.0	SY	95		
<b>Subtotal for Paving</b>							
<b>Storm Drainage</b>							
A29	NCDOT 414	N/A	Foundation Conditioning Material, Box Culvert	TN	80		
A30	NCDOT 840	NCDOT 840.04/840.05	Open Throat Catch Basin (0 to 5-feet)	EA	1		
A31	NCDOT 840	NCDOT 840.54	Manhole Frame and Cover	EA	1		
A32	NCDOT 310	NCDOT 300.01	15-inch R.C. Pipe Culverts, Class III (0 to 5-feet)	LF	62		
A33	NCDOT 310	NCDOT 300.01	18-inch R.C. Pipe Culverts, Class III (0 to 5-feet)	LF	56		
A34	NCDOT 310	N/A	15-inch Pipe End Section	EA	1		
A35	NCDOT 310	N/A	18-inch Pipe End Section	EA	3		
A36	NCDOT 420	N/A	Class A Concrete	CY	33		
A37	NCDOT 425	N/A	Reinforcing Steel	LB	2169		
A38	30 11 23	N/A	Pre-Cast Concrete Box Culvert (12-foot wide by 8-foot high, 62.5-foot CL)	LS	1		
<b>Subtotal for Storm Drainage</b>							
<b>Utilities</b>							
A39	NCDOT 1510	N/A	8-inch Water Line (DIP)	LF	78		
A40	NCDOT 1510	N/A	8-inch 4-Bend (DIP)	EA	1		
A41	NCDOT 1520	N/A	10-inch Sanitary Gravity Sewer (PVC)	LF	35		
A42	NCDOT 1520	N/A	10-inch Sanitary Gravity Sewer (DIP)	LF	71		
A43	NCDOT 1525	N/A	4-foot Diameter Utility Manhole (0 to 6-feet)	EA	3		
A44	NCDOT 1525	N/A	4-foot Diameter Utility Manhole Wall	LF	22		
A45	NCDOT 840	N/A	Manhole Frame and Cover	EA	3		
A46	NCDOT 1520	N/A	4-inch Sanitary Gravity Sewer (PVC, Lateral)	LF	15		
A47	NCDOT 1540	N/A	16-inch Encasement Pipe (Steel)	LF	30		
A48	NCDOT 1540	N/A	20-inch Encasement Pipe (Steel)	LF	41		
A49	30 11 00	N/A	Utility Line/Pole Relocation and Coordination Allowances	LS	1	\$10,000.00	\$10,000.00
<b>Subtotal for Utilities</b>							
<b>Miscellaneous</b>							
A50	NCDOT 800	N/A	Mobilization (Single Large Project)	LS	1		
A51	30 11 00	N/A	Testing and Inspecting Allowances	LS	1	\$10,000.00	\$10,000.00
A52	30 11 00	N/A	Construction Surveying and As-Built Survey	LS	1		
<b>Subtotal for Miscellaneous</b>							
<b>Total for SD-2020-04</b>							

# CONTRACT: SD-2020-04

## Project: Alpine Road Culvert Replacement

### Project Special Provisions and Technical Specifications Seals

 <p>NCBELS NO: C-0676</p> <p>Not Responsible for Structural Specifications</p>	 <p>DocuSigned by: 1/14/2020 DB3C8E45B06D499...</p> <p><b>NCBELS NO. C-0764</b></p> <p>Structural Specifications Only</p>

# ALPINE ROAD

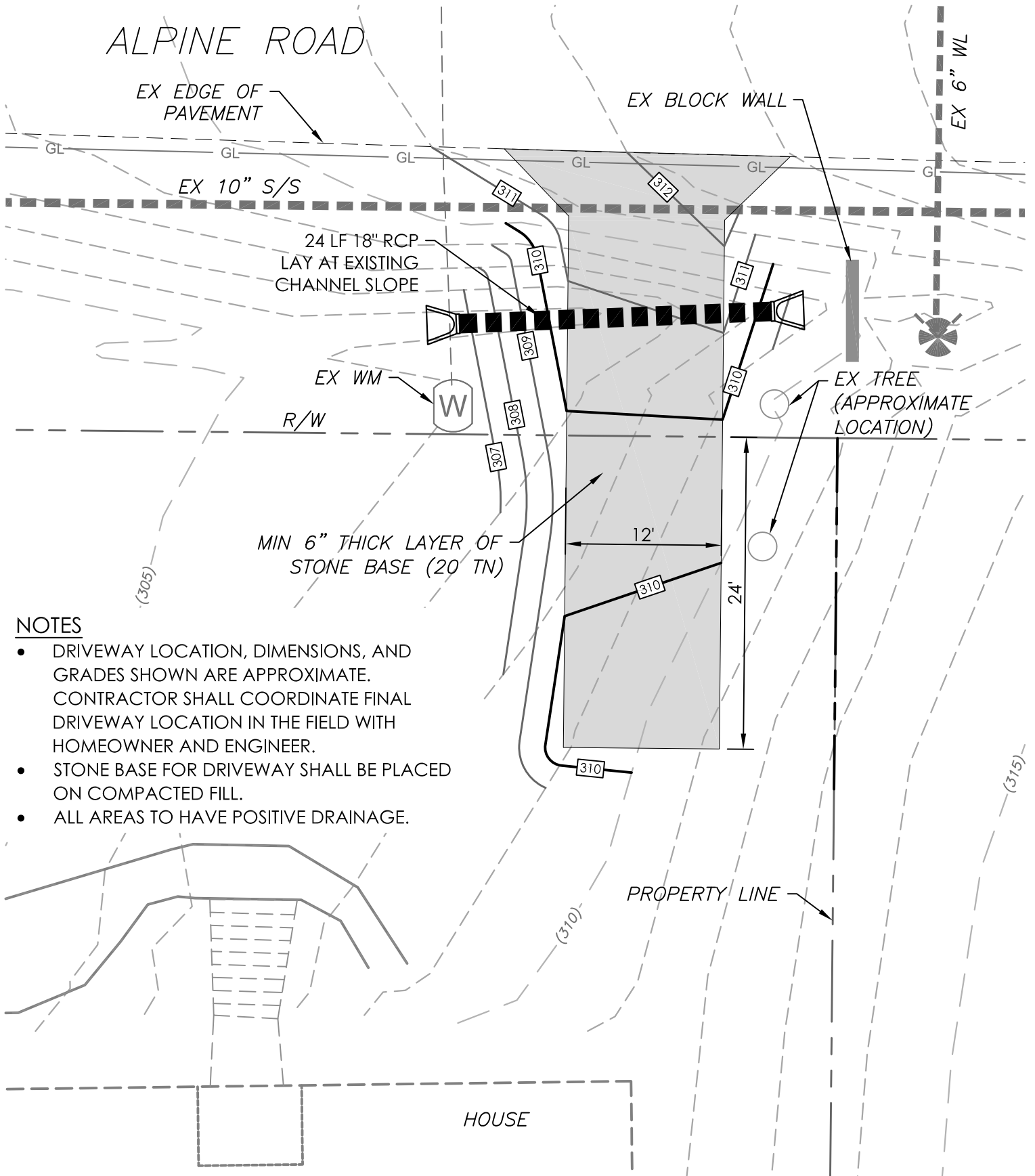

## NOTES

- DRIVEWAY LOCATION, DIMENSIONS, AND GRADES SHOWN ARE APPROXIMATE. CONTRACTOR SHALL COORDINATE FINAL DRIVEWAY LOCATION IN THE FIELD WITH HOMEOWNER AND ENGINEER.
- STONE BASE FOR DRIVEWAY SHALL BE PLACED ON COMPACTED FILL.
- ALL AREAS TO HAVE POSITIVE DRAINAGE.

# 2431 ALPINE ROAD DRIVEWAY PLAN

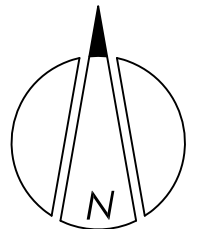
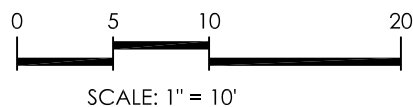

Clarification was sought on detail C-1 on Drawing C302 during the Pre-Bid Conference held on January 6, 2020. Clarification provided below.

The sketch below reflects the configuration of the sills in the culvert.

Culverts with a longitudinal slope between 0.5%-1.0% (this culvert is 0.7%), will utilize 1-foot high sills at the upstream and downstream ends. To maintain the natural channel width and low flow velocities, alternating 6-foot wide by 2-foot high baffles are specified per the detail. The sill/baffle structure is combined at the upstream and downstream ends and is stepped as shown.

Backfill at a minimum is placed within the 1-foot vertical portion of the culvert that is buried below the streambed elevation. More native material can be placed in front of the 2-foot high sills if needed, but is not necessary and may cause more sediment export downstream. Sedimentation will occur naturally over time and create the low flow channel as depicted in the plan view.

